

APPLY LUBRICANT TO ALL SEALS PRIOR TO INSTALLATION
DO NOT USE SILICONE TYPE LUBRICANTS.

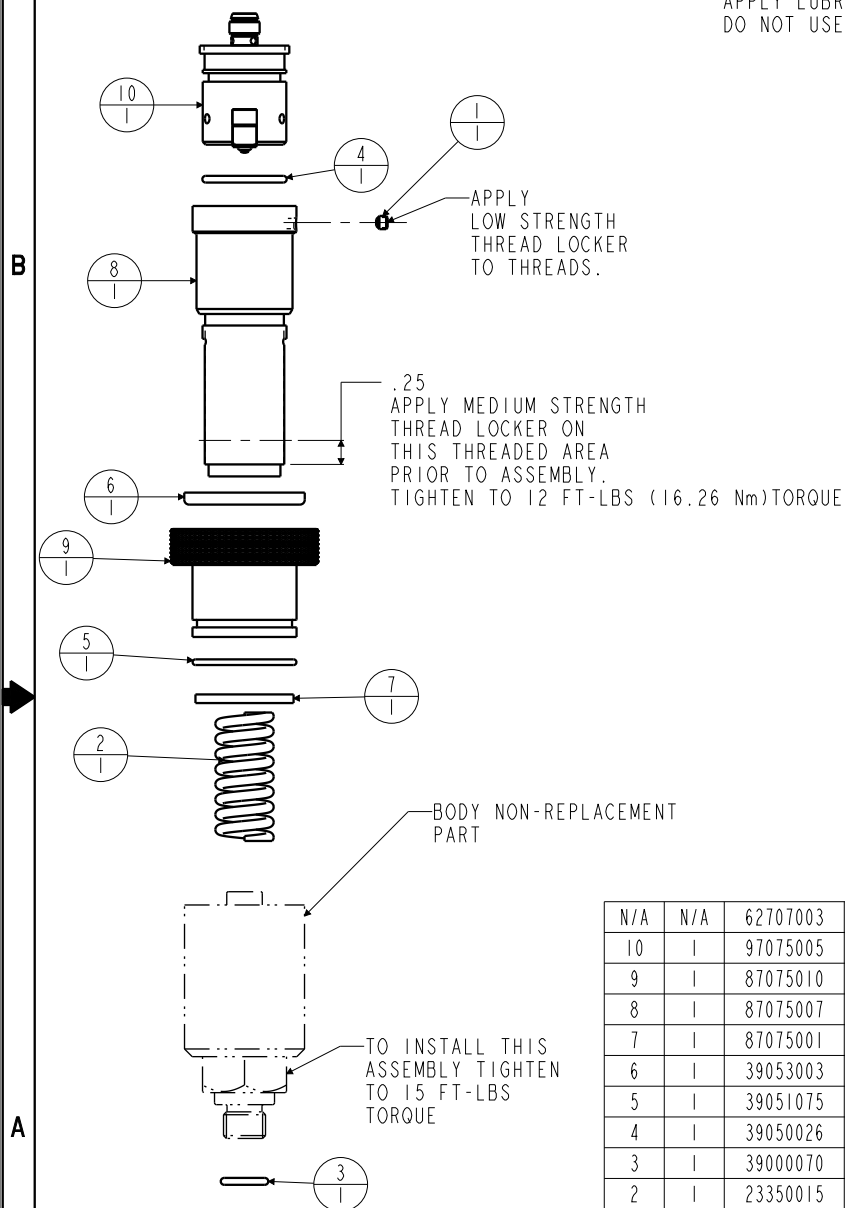

N/A	N/A	62707003	KIT, REPAIR, SWITCH, PRESS	NOTED
10	1	97075005	ASSY, SWITCH, PRESS, M8	X
9	1	87075010	ADJUSTER, SWITCH, PRESSURE, SEVERE	
8	1	87075007	COLLAR, SWITCH, PRESSURE	
7	1	87075001	SHIM, ENDED, DOUBLE	
6	1	39053003	WIPER, PRESS-IN, (1)	
5	1	39051075	O-RING, (24.5mm x 1.5)	
4	1	39050026	O-RING, (-018)	X
3	1	39000070	O-RING, (-904)	X
2	1	23350015	SPRING, COMPRESSION	
1	1	21440022	SHSS, CUP POINT	
No.	QTY	PART No.	DESCRIPTION	Included in Repair Kit

PARTS LIST



VEKTEK, INC.
1334 E. SIXTH AVE. P.O. BOX 625
EMPORIA, KS. 66801 U.S.A.

ASSEMBLIES AFFECTED
70-7500-74

PARTS LIST, ASSY, SWITCH, PRESS, M8 MALE

SIZE
A PL7178

REV
C

C	5303	RELEASE	JDW	05/01/24
REV	IN ACCORDANCE WITH ECN	EFFECTIVE DATE	REVISED BY	DATE
DRW BY:	DRAWING STATUS: Released			
DATE: 7-13-11	PRODUCTION APPROVED FOR RELEASED STATUS ONLY			

FORM FEG035_PL_ASIZE, REV. B

SHEET 1 OF 1